

Acionar e libertar o travão

Aplicar travão

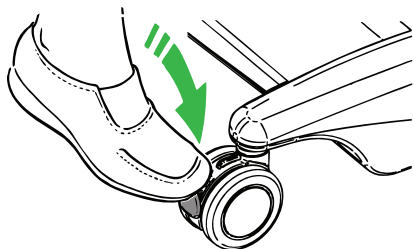

Apenas para armazenamento e em plano inclinado. Não aplique os travões quando estiver a elevar um paciente de qualquer outra forma.

Liberte o travão

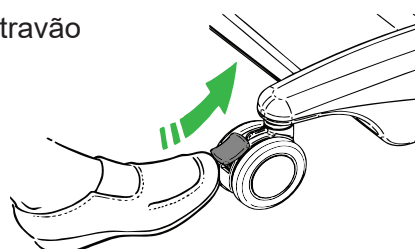

Botões no painel de controlo e no controlo manual

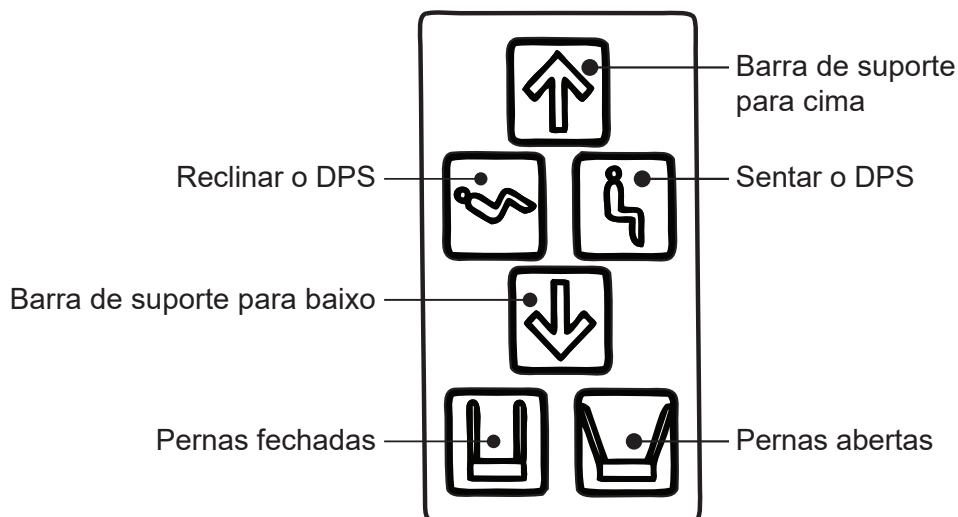
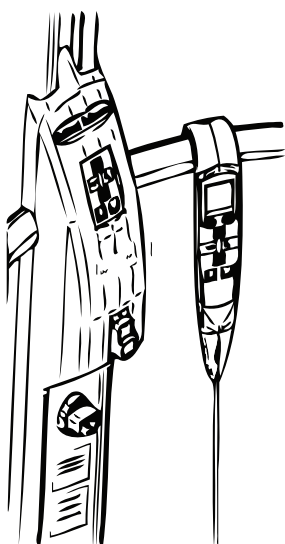

Fixação da funda com alças

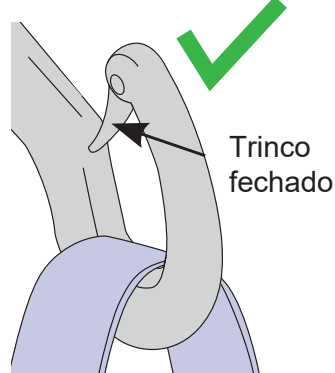
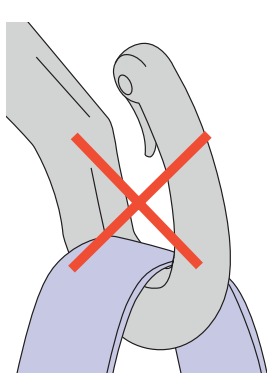

Fixação da funda com gancho

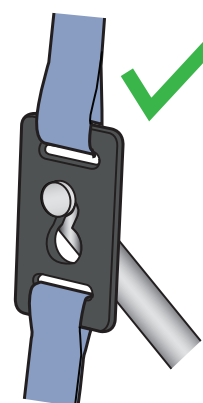
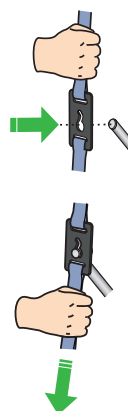

Instale e fixe o gancho na presilha antes de elevar o paciente.

Retirar a fixação

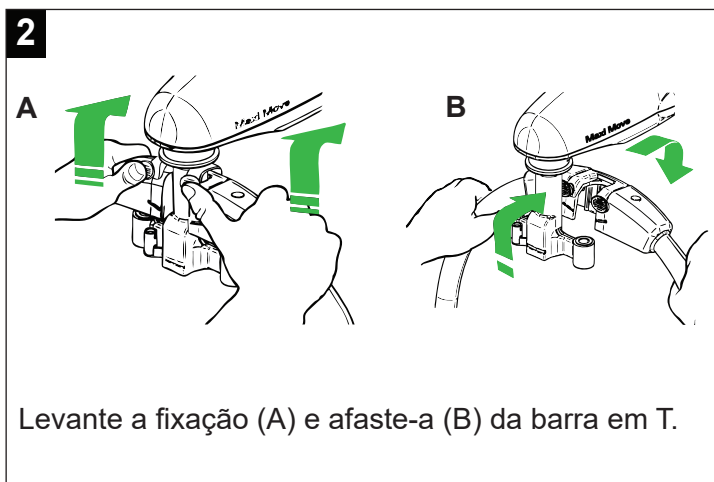
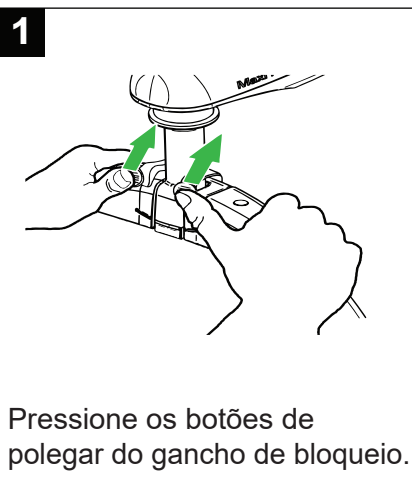
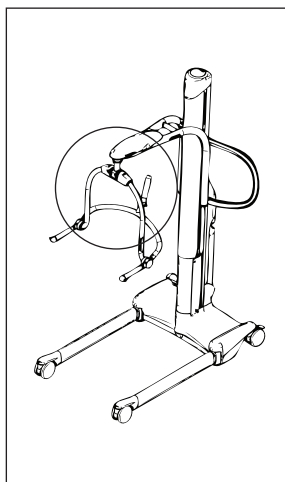

Instalar a fixação

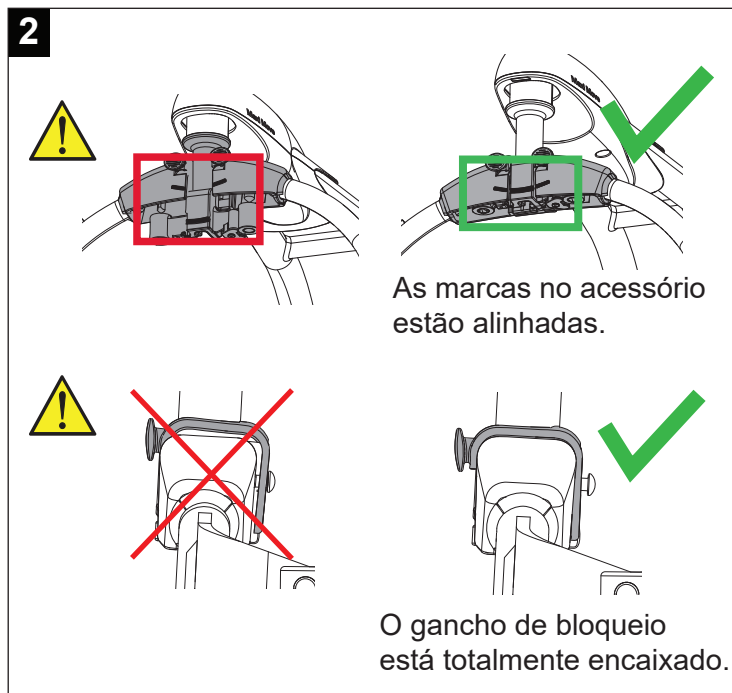
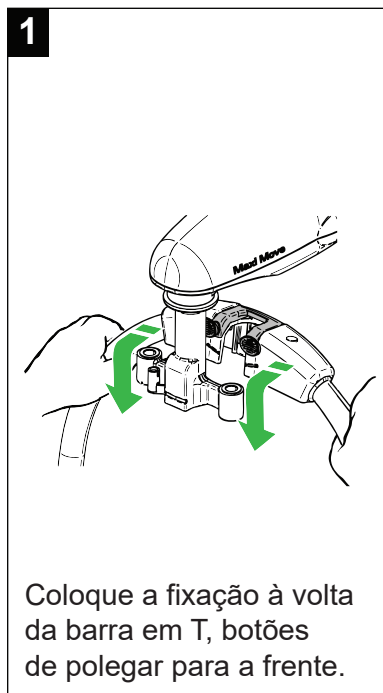
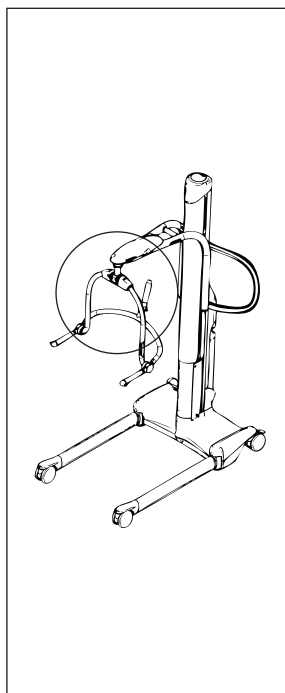

Falha na corrente elétrica – baixe o braço de elevação

